

# Stevenson Elem. School

## Phase 2 & 3: Modular Bldgs & MUR / Library

**Construction**  
Sept 2017 - August 2018

**Move-in**  
August 2018

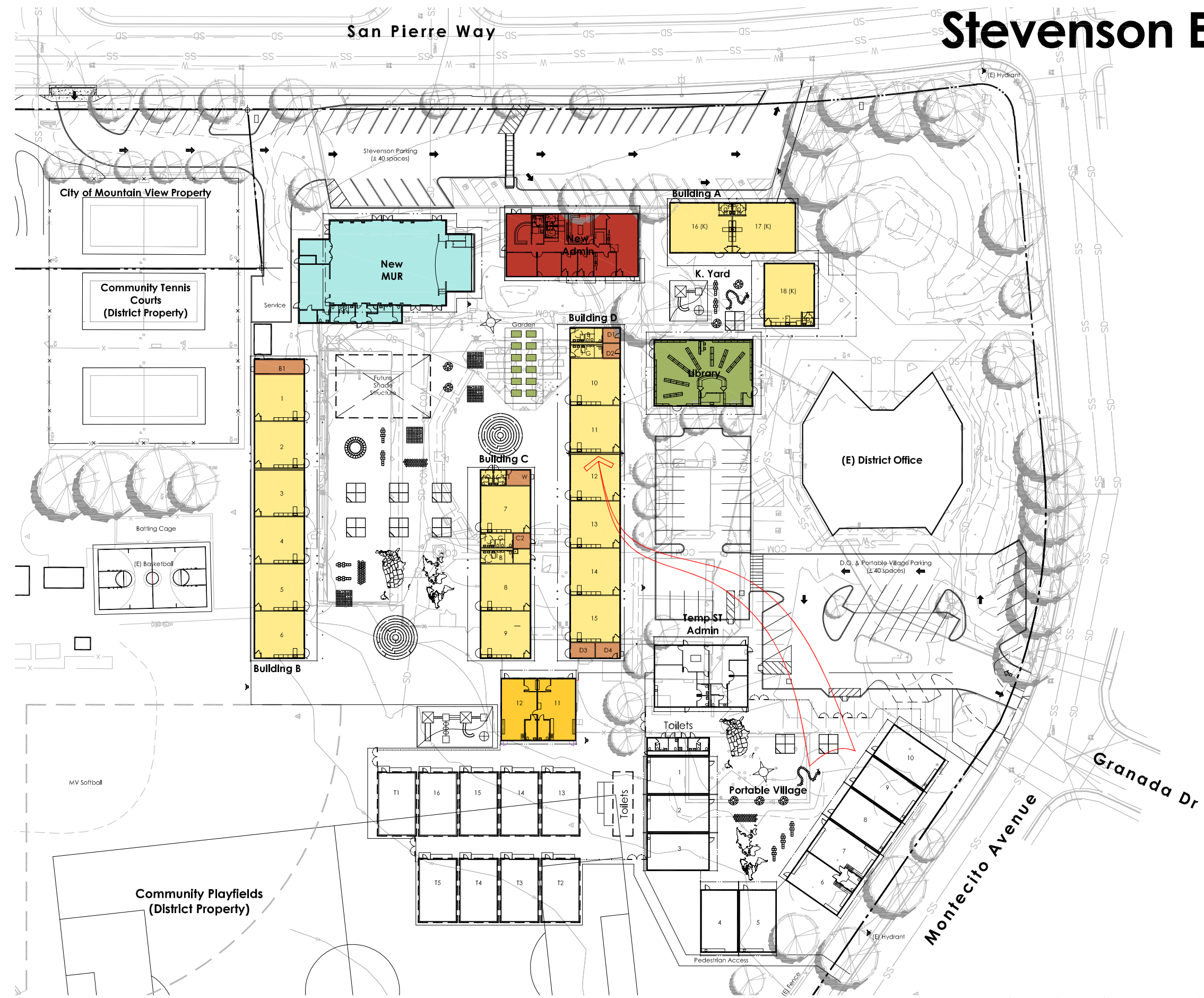

- Legend
- Admin Building
  - MUR Building
  - Classrooms
  - Temp. Housing (Leased Portables)
  - Specialist or Breakout Spaces
  - Flex Classrooms (Portables)

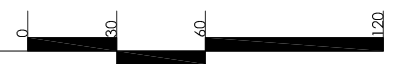
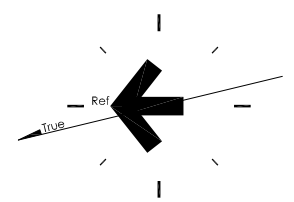

1 Stevenson / Preschool / District Office - Master Plan